

Quality Heavy Duty Water Pumps

Ford®

7316X

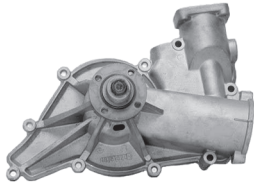

Engine: Ford® 7.3
(Direct Engine) 445
OEM #: F4TZ8501ARM
Casting #: 1818182C3, 4
Repair Kit: N/A
Gasket Kit: N/A
New Pump #: N/A
Notes:

Ford®

7317X

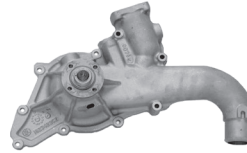

Engine: Ford® 7.3
Direct Engine (445)
OEM #: E7TZ8501ARM
Casting #: 1823423C2
Repair Kit: N/A
Gasket Kit:
New Pump #: N/A
Notes: 1997 Application.

Ford®

7318X

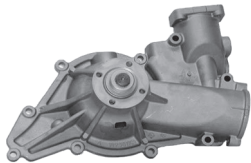

Back View

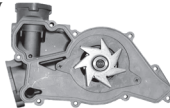

Engine: Ford® 7.3 Direct
Engine (445)
OEM #: E6TZ8501A, BRM
Casting #: 1823611C1
Repair Kit: N/A
Gasket Kit:
New Pump #: N/A
Notes: 1998 & Up Applications.

Ford®

7319X



Engine: Ford® 6.6 Engine (401)
OEM #: E1HZ8501DRM
F1HZ8501D
Casting #: E8HN - 8508AB
Repair Kit: N/A
Gasket Kit:
New Pump #: 2319
Notes:

Ford®

7320X

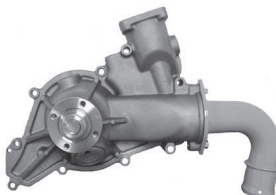

Engine: Ford® 7.3L
Turbo Diesel (466)
OEM #: E6TZ-8501AA,
F7TZ8501-BRM, 8IZ8501ARM
Casting #:
Repair Kit: N/A
Gasket Kit:
New Pump #: 2320
Notes: 2-Piece Design/
Aluminum Housing. 1996 & Up
Applications.

Thermo-King®

7350X

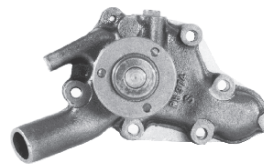

Engine: Thermo-King®
Isuzu C201
OEM #: 11-4576
Casting #: ph374
Repair Kit: N/A
Gasket Kit: 2350G
New Pump #: 2350
Notes:

Thermo-King®

7351X

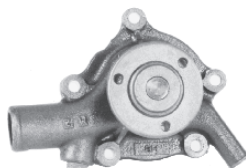

Engine: Thermo-King®
2.2 Liter Direct Injection
OEM #: 11-5858
Casting #: M1 or M2
Repair Kit: N/A
Gasket Kit: 2351G
New Pump #: 2351
Notes: